

# COLFAX TOWNSHIP

100th Ave / Road 845

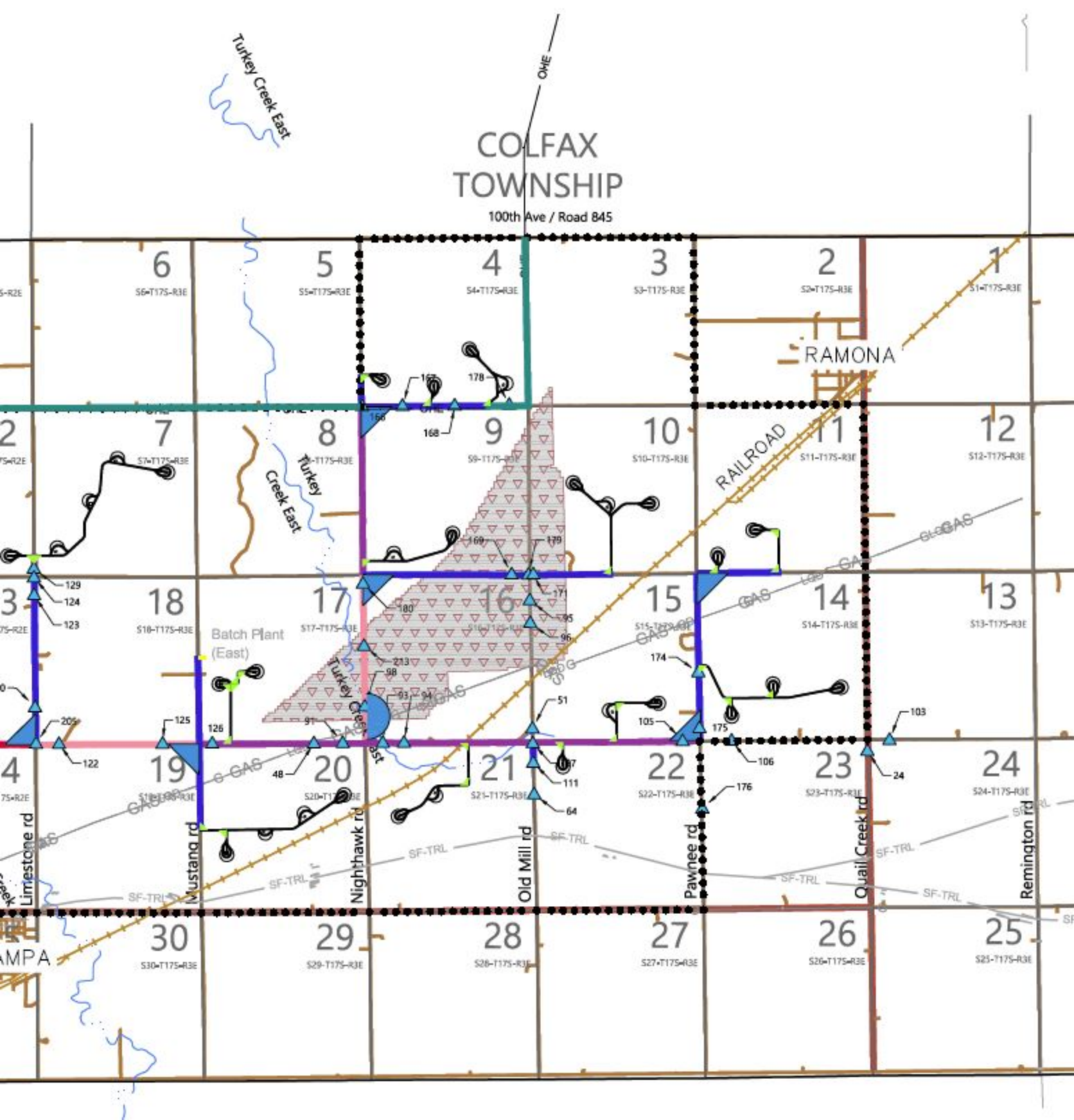

GAS — "East Leg Natural Gas" Transmission Line (North Line)  
8.625' Diameter Natural Gas  
Owner: Mid-America Pipeline Co. LLC.  
Operator: Enterprise Products Operating, LLC

G — "East Leg Natural Gas" Transmission Line (Middle Line)  
8.625' Diameter Natural Gas  
Owner: Mid-America Pipeline Co. LLC.  
Operator: Enterprise Products Operating, LLC

LQD — "East Leg Liquids" Transmission Line (South Line)  
8.625' Diameter Ethane, Propane, Natural Gasoline  
Owner: Mid-America Pipeline Co. LLC.  
Operator: Enterprise Products Operating, LLC

#### \*NOTE

SEE DETAIL SHEETS 029 & 030 FOR ACCESS ROAD SECTIONS

SEE SHEET 014 FOR PUBLIC ROAD IMPROVEMENT TABLES

ROAD IMPROVEMENTS PER AET  
(REPORT OF PRE-CONSTRUCTION PAVEMENT RECOMMENDATIONS)  
(DATED 12-29-17)

B/A 2" (BLADE/ADD 2")  
58,745' — 11.1 MILES

OV 4" (ADD 4" OVERLAY)  
81,215' — 15.4 MILES

OV 6" (ADD 6" OVERLAY)  
29,724' — 5.6 MILES

SFDR 8" CEMENT STABILIZATION W/ 4" CAP)  
19,424' — 3.7 MILE

SFDR 12" CEMENT STABILIZATION W/ 4" CAP)  
47,925' — 9.1 MILES

44.9 MILES OF ROAD IMPROVEMENT

#### LEGEND:

..... PROPOSED PROJECT BORDER

OHE — PROPOSED TRANSMISSION LINE

S PROPOSED SUBSTATION

L PROPOSED LAY DOWN YARD

M PROPOSED OPERATIONS AND MAINTENANCE

INT-XX PROPOSED INTERSECTION

PROPOSED INTERSECTION IMPROVEMENT  
PUBLIC ROAD TO PUBLIC ROAD

PROPOSED TEMPORARY INTERSECTION IMPROVEMENTS  
(PUBLIC TO PRIVATE AND PRIVATE TO PRIVATE)

EXISTING RAILROAD

EXISTING ROAD

EXISTING SECTION LINE

EXISTING CULVERT

EXISTING BRIDGE

EXISTING WATER COURSE

SF-TRL — EXISTING SANTA FE TRAIL

CH-TRL — EXISTING CHISHOLM TRAIL

EXISTING AUDUBON IBA  
(NO ABOVE-GROUND PERMANENT IMPACTS)



( IN FEET )  
1 inch = 3600 ft.



**ATWELL**

866.850.4200 [www.atwell-group.com](http://www.atwell-group.com)

143 UNION BOULEVARD, SUITE 700  
LAKEWOOD, CO 80228  
303.462.1100



	04/23/18	REVISED PLANS R2		
	03/14/18	IFC PLANS R1		
	11/10/2017	VALIDATED 30% DESIGN PLANS		
	11/3/2017	BASIC DESIGN PLANS		
REV.	DATE	DESCRIPTION	PREPARED	CHECKED

CONTRACTOR'S LOGO	PROJECT: <b>DIAMOND VISTA WIND PROJECT</b> <b>MARION COUNTY, KANSAS</b>
	FILE NAME:

 Engineering & Construction <b>EGP VALIDATION</b>	CLASSIFICATION:	FORMAT: <b>ANSI D</b>	SCALE:	PLOT SCALE:
	UTILIZATION SCOPE:	TITLE: <b>CIVIL SITE PLANS</b> <b>PUBLIC ROAD IMPROVEMENT PLANS</b>  TURBINE ARRAY: DIAMOND VISTA A034R4		
VALIDATED BY: <b>JM BALLESTA</b>				