

MARION COUNTY KANSAS
OFFICE OF THE PLANNING COMMISSION

P.O. BOX 157
 MARION, KANSAS 66861
 PHONE (620) 382-2550
 Toll Free 1-800-305-8848

Per Marion County Zoning Regulations: All surrounding property owners within 1,000 feet of an area proposed to be changed, shall be notified by mail twenty (20) days prior to the public hearing. If you are receiving this notice, you are within 1,000 feet of a property whose owner has made application to the Marion County Planning Commission for a variance. If you will read the notice on this page, it will tell you who the property owner is, what they are requesting, and when the public hearing will be held. You may attend this hearing at the date and time listed below.

T-19-20-S

R-3-4-E

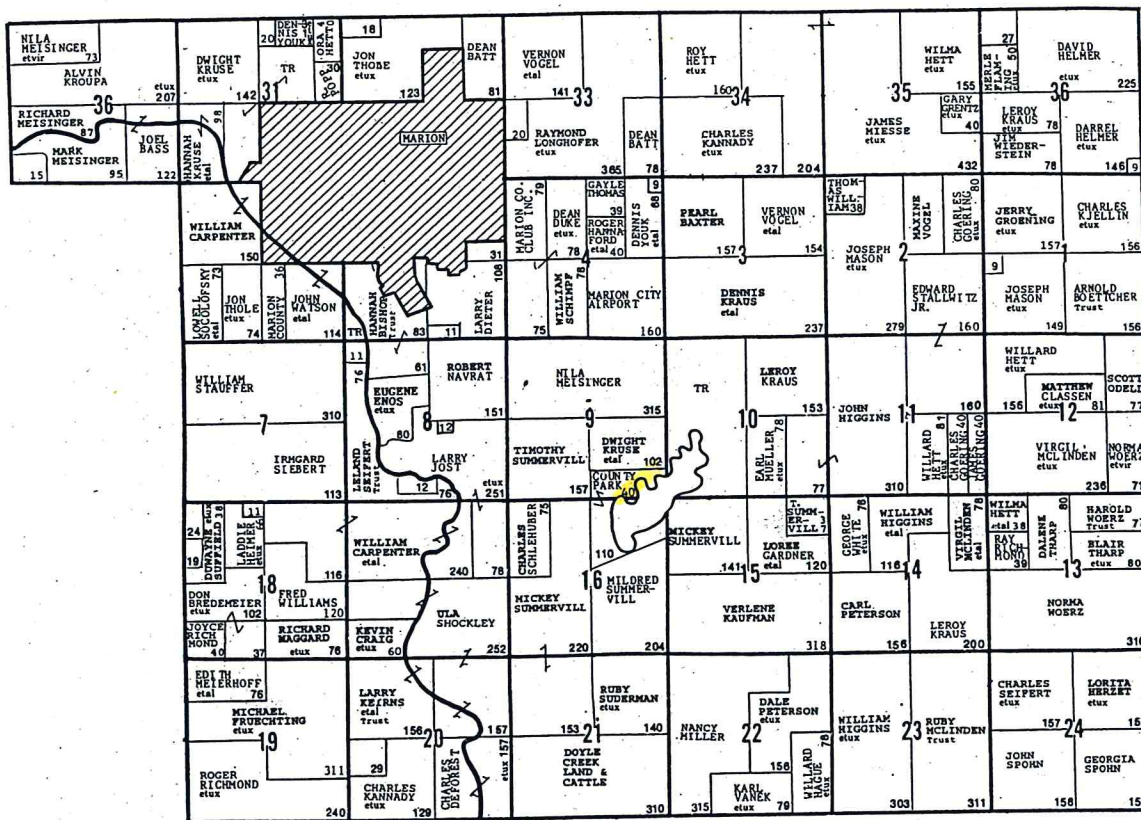

(First Published in the Marion County Record, Hillsboro Star, Peabody Gazette, Wednesday, August 6, 2003)

**NOTICE
 PUBLICATION
 Variance Pending**

Application: Edith Graber
 Variance: From required rear setback of 20 feet to 6 feet, required side setback from 10 feet to 8 feet on the East side.
 Address: 12 Lakeshore Drive, Marion, Ks 66861
 Legal Description: Pt of SE ¼ of Sec 9-T20S-R4E

**Public Hearing
 Marion Co. Board of Zoning Appeals
 August 28, 2003
 Marion County Courthouse
 7:30 PM**