

178-33-0-00-00-001-00-0

PC-18-05

APPLICATION FOR CONDITIONAL USE PERMIT

This is an application for a Conditional Use Permit. The form must be completed and filed at the office of the Zoning Administrator in accordance with directions on the accompanying instruction sheet.

AN INCOMPLETE APPLICATION CANNOT BE ACCEPTED.

1. Name of applicant or applicants (owner (s) and/or their agent (s)). All owners of all property requested to be rezoned must be listed on this form.

A. Applicant/Owner Joel Suderman Trust
 Address 1337 Old Mill, Marion, KS 66861 Phone _____
 Agent Expedition Wind, LLC - Patrick Pelstring (President)
 Address 1907 Wayzata Blvd. 220 Wayzata, MN 55391 Phone 952-473-7500

B. Applicant/Owner _____
 Address _____ Phone _____
 Agent _____
 Address _____ Phone _____

C. Applicant/Owner _____
 Address _____ Phone _____
 Agent _____
 Address _____ Phone _____

2. The applicant hereby requests an exception as a conditional use permit for the purpose of establishing a Meteorological Tower

on property legally described as Lot(s) _____ Block(s) _____ of the
 _____ Addition. S33, T20, R03, ACRES 157.93, NE/4 LESS ROW Deed Book/
 Page 335 /277 377 /796

(Metes and bounds descriptions shall be provided in the space below or on an attached sheet.)

A meteorological tower will be established for the purpose of collecting and analyzing
 wind speed data. The meteorological tower will stand at less than 60 meters above ground
 with 4 sets of guy wires to anchor the structure to driven stakes. The whole area is expected to be
 a 200'x200' square with metal fence around the guy wires and tower base for general safety
 and protection from animals.

3. Development plan included?

Yes

No

4. The general location may be described as agriculture zoned land.

5. I request this conditional used permit for the following reasons: _____
To use a portion of agricultural land for the purpose of constructing and maintaining a meteorological tower in a general agreement with a landowner in exchange for an annual payment. Measurements will be used to assess the wind energy resource.

6. I (we), the applicant(s), acknowledge receipt of the instruction sheet explaining the method of submitting this application. I (we) realize that this application cannot be processed unless it is completely filled in; is accompanied by an ariel photo as required in the instruction sheet; and is accompanied by the appropriate fee.

Signature of Record Land Owner: (Use separate sheet if necessary for names of additional owners/applicants.)

Patrick Pelstring
(Owner)

(Owner)

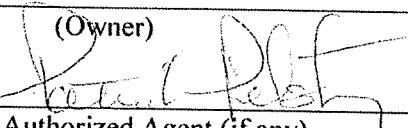
(Owner)
By 
Authorized Agent (if any)

(Owner)
By _____
Authorized Agent (if any)

7. Office Use Only:

This application was received at the office of the Zoning Administrator at 2:07 (P.M.) on 6/29/18. It has been checked and found to be completed and accompanied by required documents and the appropriate fee of \$200.00

Planning & Zoning Assistant

6/29/18
Date

Planning & Zoning Director

6/29/18
Date

Case Number: PC-18-05

Date of Public Hearing: July 26, 2018

Date of Approval/Disapproval by Planning Commission: _____

Date of Recommendation to the County Commission: _____

Date of County Action: _____

Receipt # 381595
6/28/18

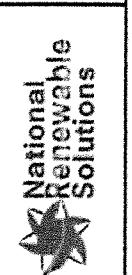
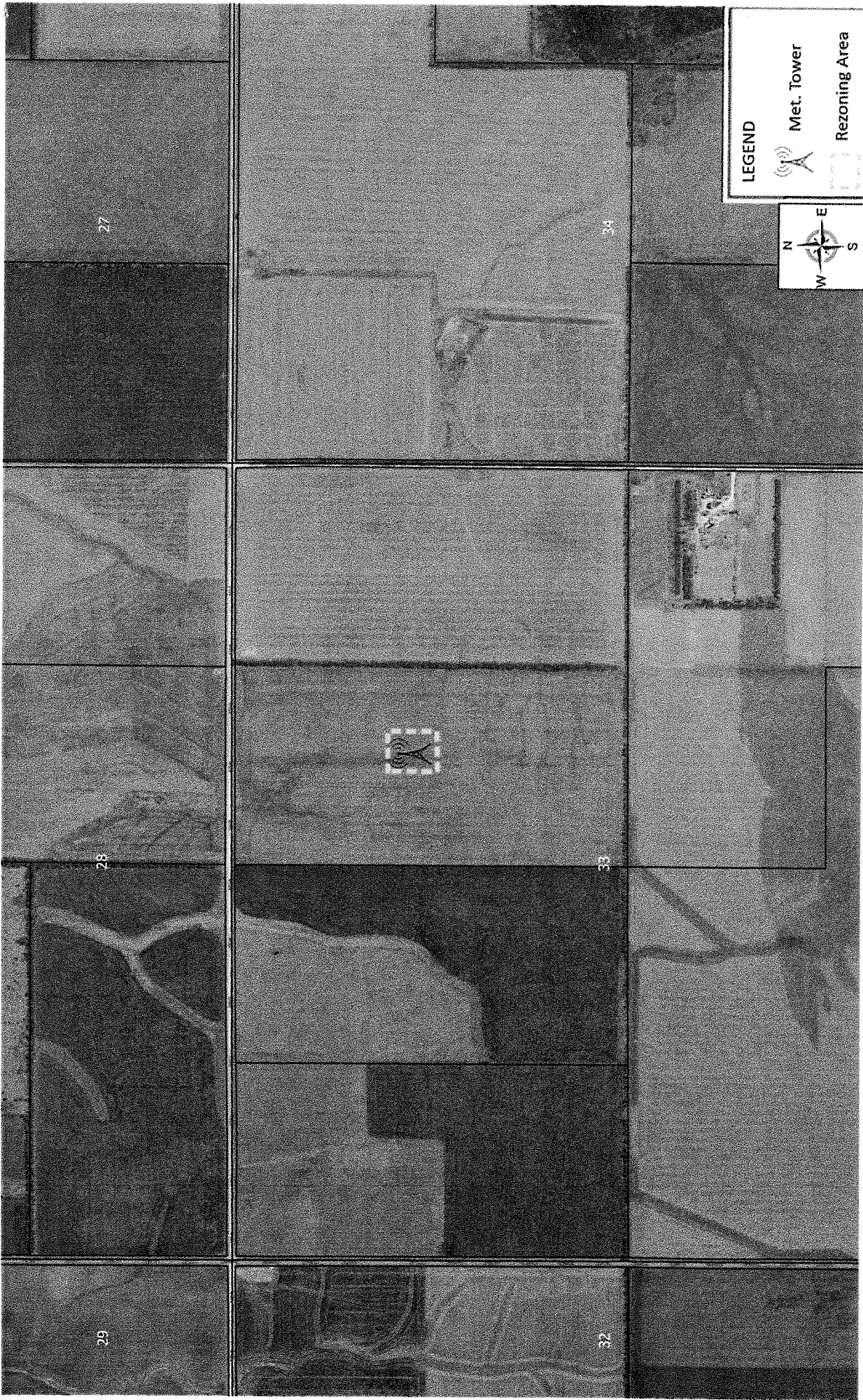

Received 7/10/18



National Renewable Solutions
 1907 Wayzata Blvd, Suite 220
 Wayzata, MN 55391
 Office: 952.473.7500
www.natrs.com

**Conditional Use Permit
 Rezoning Area**

Landowner: Joel Suderman Trust
 Location: Section 33; Township 20; Range 3 (2 acres)
 Current Zoning: Agriculture

LEGEND
 Met. Tower
 Rezoning Area

This information is confidential and proprietary to National Renewable Solutions and is not intended for replication or distribution.

