

MARION COUNTY COURTHOUSE

MARION COUNTY, KANSAS
PLANNING COMMISSION/BOARD OF ZONING APPEALS

203 SOUTH THIRD
MARION, KANSAS 66861
PHONE: 620-382-2945

July 6, 2018

Property Owner Notification

Re: Case No. PC-18-05 - Public Hearings to consider a conditional use permit

Dear Property Owner:

Please find enclosed a copy of the legal notice for the above referenced public hearing, filed by **Expedition Wind, LLC**, on behalf of **Joel Suderman Trust**, to install a **Meteorological Tower on the NE ¼ of Section 33, Township 20 South, Range 03 East of the 6th P.M., Marion County, Kansas.**

A copy of the legal description is available for inspection at the Planning and Zoning Department at 203 S. Third Street in Marion during normal business hours. The Marion County Planning Commission and Board of Zoning Appeals will hold a public hearing on this case on **Thursday, August 2, 2018 at 7:00 p.m.**, at the Marion County Lake Hall, 1 Office Drive, Marion, Kansas.

If you have any questions, please do not hesitate to contact this office.

Sincerely,

A handwritten signature in cursive script that reads "Sharon Omstead".

Sharon Omstead, Assistant
Marion County Planning and Zoning

Enclosure

(First Published in The Marion County Record, Hillsboro Star-Journal, and Peabody Gazette-Bulletin on Wednesday, July 11, 2018)

**NOTICE OF PUBLIC HEARING
MARION COUNTY PLANNING COMMISSION AND BOARD OF ZONING APPEALS**

TO WHOM IT MAY CONCERN:

Notice is hereby given that on **Thursday, August 2nd, 2018, at 7:00 p.m.** at the Marion County Lake Hall, 1 Office Drive, Marion, Kansas, the Marion County Planning Commission and Board of Zoning Appeals will conduct a public hearing on **Case No. PC-18-05**, the application of **Expedition Wind, LLC, on behalf of Joel Suderman Trust, to install a Meteorological Tower on the NE ¼ of Section 33, Township 20 South, Range 03 East of the 6th P.M., Marion County, Kansas.** A copy of the legal description of the property in question is available for inspection at the Planning and Zoning Department at 203 S. Third St, Marion, Kansas during normal business hours.

All persons wishing to be heard regarding this matter may submit written comments to the Marion County Planning Commission and Board of Zoning Appeals prior to the public hearing; or may present ~~written and/or oral~~ comments at such public hearing. Upon conclusion of said public hearing the Planning Commission and Board of Zoning Appeals may make a recommendation to the governing body or may continue consideration of this matter to a future date without further notice.

Dated this 6th day of July, 2018

/s/ Emma Tajchman
Emma Tajchman, Secretary

PC-18-05 Notification Area

PIN	Owner	Owner Address	Owner City	Owner State	Owner ID	Description
057-178-28-0-00-00-007.00-0	QUALLEY, WAYNE C & DEANNA G TRUST	2601 BOULDER WAY	BURNSVILLE	MN	55337	E/2 SE/4 LESS ROW
057-178-33-0-00-00-004.01-0	HIEBERT, MARILYNN K	3308 TUSCANY HILL CT	BRIDGETON	MO	63044	SW4 & SW4 SE4 LESS ROW
057-178-34-0-00-00-006.00-0	SUDERMAN, RODNEY E TRUST	1255 OLD MILL	MARION	KS	66861	NW/4 NE/4 & ALL NW/4 LESS ROW
057-178-33-0-00-00-002.00-0	LITKE, VIRGIL G TRUST	1373 MUSTANG	MARION	KS	66861	E/2 NW/4 LESS ROW
057-178-34-0-00-00-007.00-0	SUDERMAN, JERRY D REVOCABLE TRUST	1333 KANZA	HILLSBORO	KS	67063	W/2 SW/4 LESS ROW
057-178-28-0-00-00-005.00-0	PAUL, NANCY A REVOCABLE TRUST	3110 W SUNSET	SPRINGFIELD	MO	65807	S/2 SW/4 LESS ROW
057-178-27-0-00-00-003.00-0	FROMM, ROBERT SR FAMILY TRUST	1105 N 80TH ST	KANSAS CITY	KS	66112	W/2 SW/4 LESS ROW
057-178-28-0-00-00-006.00-0	SUDERMAN, JOEL E TRUST	1337 OLD MILL	MARION	KS	66861	W/2 SE/4 LESS ROW
057-178-33-0-00-00-001.00-0	SUDERMAN, JOEL E TRUST	1337 OLD MILL	MARION	KS	66861	NE/4 LESS ROW
057-178-33-0-00-00-004.00-0	SUDERMAN, JOEL E TRUST	1337 OLD MILL	MARION	KS	66861	E2 SE4 & NW4 SE4 LESS ROW

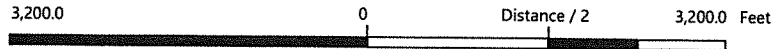
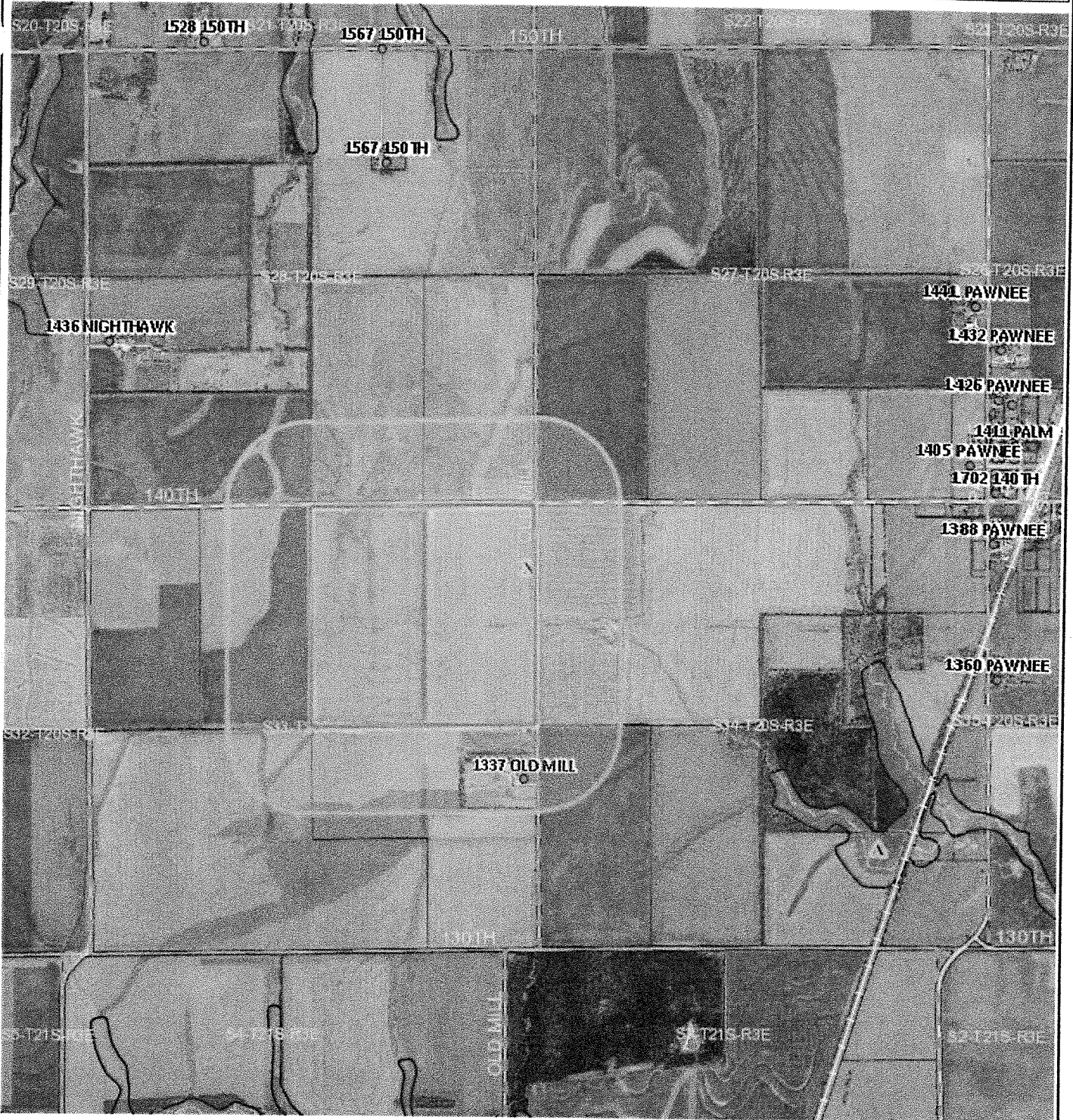

NAD_1983_StatePlane_Kansas_South_FIPS_1502_Feet

Notes

- City Boundary
 - Section Line
 - Parcels
 - ROAD ROW
 - Flood Hazard Area
 - 0.2 PCT ANNUAL CHANCE FLOOD HAZARD
 - A: 1% annual chance, no BFEs
 - AE: 1% annual chance, with BFEs
 - AH: 1% chance w/ BFEs, 1-3 ft
 - X: minimal flood hazard
 - X PROTECTED BY LEVEE
 - Centerlines
- 1: 19,200
- Date Printed: 7/6/2018**
© R&S Digital Services, Inc.

This map is a user generated static output from an Internet mapping site and is for reference only.
Data layers that appear on this map may or may not be accurate or current.
THIS MAP IS NOT TO BE USED FOR NAVIGATION

