

MARION COUNTY KANSAS OFFICE OF THE PLANNING COMMISSION

P.O. BOX 157
MARION, KANSAS 66861
PHONE (620) 382-2550
Toll Free 1-800-305-8848

Per Marion County Zoning Regulations: All surrounding property owners within 5,280 feet of an area proposed to be changed, shall be notified by mail at least twenty (20) days prior to the public hearing. If you are receiving this notice, you are within 5,280 feet of a property whose owner has made application to the Marion County Planning Commission to alter their zoning status. If you will read the notice on this page, it will tell you who the property owner is, what change they are requesting to be made to their property and when the public hearing will be held. You may attend this hearing at the date and time listed below.

T-21-S

WEST BRANCH PLAT
(Landowners)

R-1-E

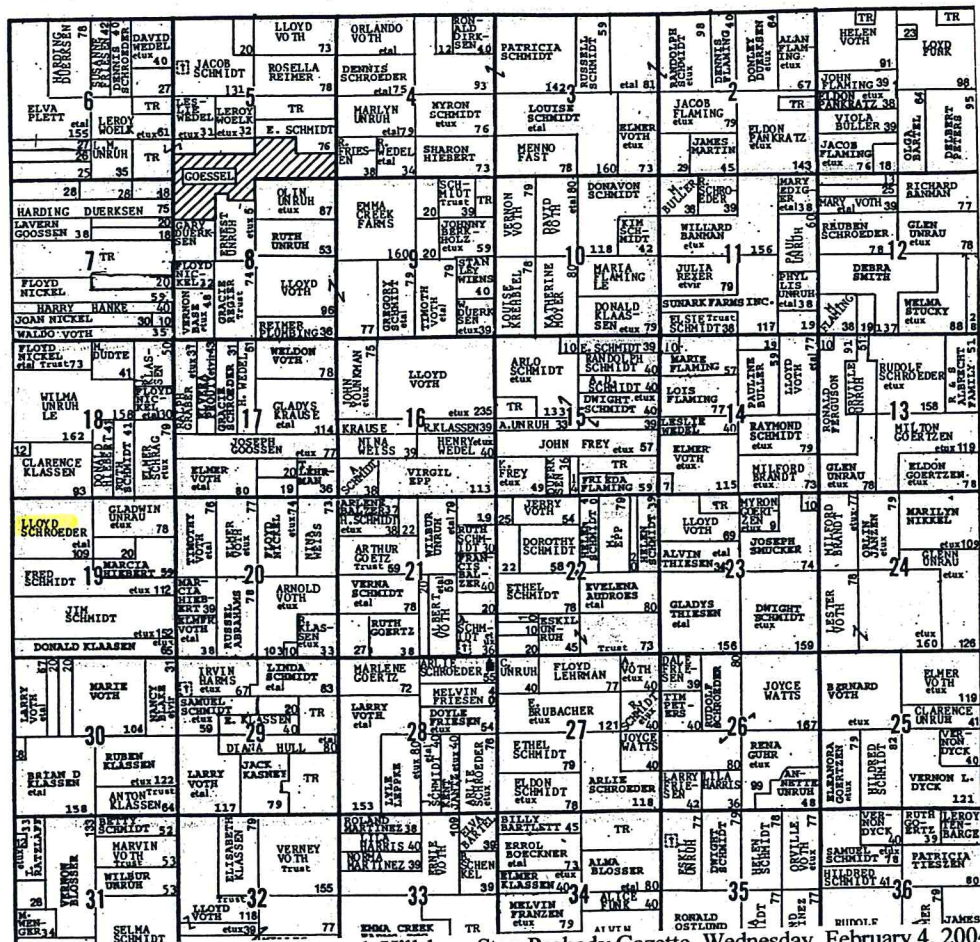

(First Published in the Marion County Record, Hillsboro Star, Peabody Gazette, Wednesday, February 4, 2004)

NOTICE PUBLICATION Conditional Use/Rezone Pending

Application: Lloyd Schroeder
Conditional Use: Tree farm operated at retail.
Rezone: From Agricultural to Rural Residential.
Address: 994 N. Meridian, Newton, KS 67114
Legal Description: Pt of NW ¼ of Sec 19-T21S-R1E

Public Hearing
Marion Co. Planning Commission
February 26, 2004
Marion County Courthouse
7:30 PM