

MARION COUNTY KANSAS

OFFICE OF THE PLANNING COMMISSION

P.O. BOX 157
MARION, KANSAS 66861
PHONE (620) 382-2550
Toll Free 1-800-305-8848

Per Marion County Zoning Regulations: All surrounding property owners within 1,000 feet of an area proposed to be changed, shall be notified by mail twenty (20) days prior to the public hearing. If you are receiving this notice, you are within 1,000 feet of a property whose owner has made application to the Marion County Planning Commission for a variance. If you will read the notice on this page, it will tell you who the property owner is, what they are requesting, and when the public hearing will be held. You may attend this hearing at the date and time listed below.

T-21-S

WEST BRANCH PLAT

R-1-E

(Landowners)

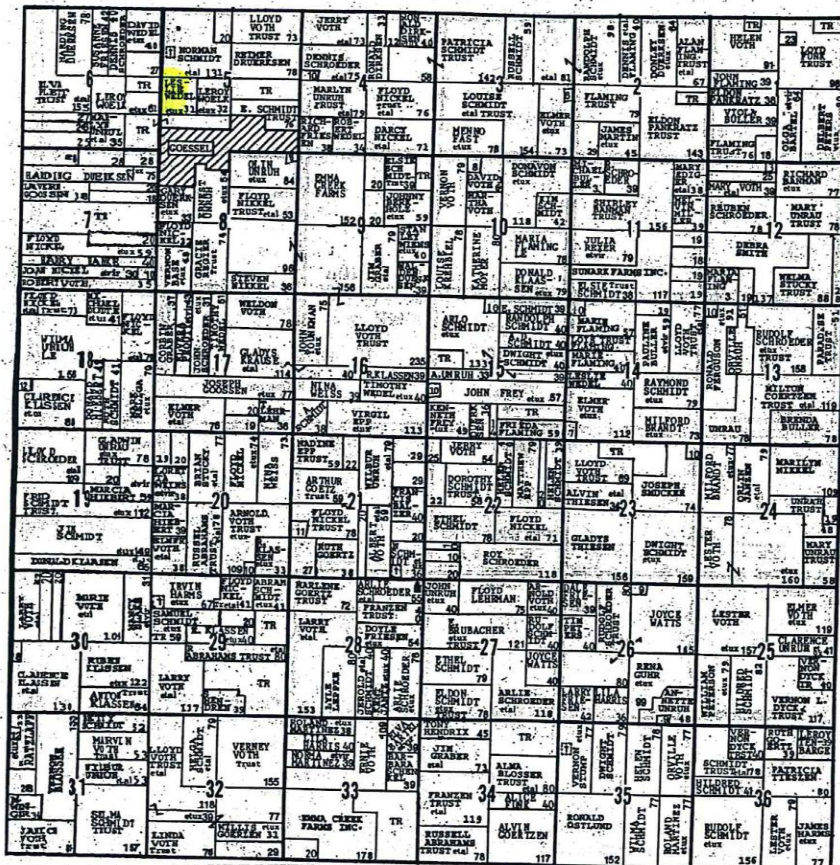

(First Published in the Marion County Record, Hillsboro Star, Peabody Gazette, Wednesday, January 5, 2005)

NOTICE PUBLICATION Variance Pending

Application: Leslie Wedel
Variance: From required 40 acres to 34 acres; From required side yard setback of 50 feet to 30 feet.
Address: 1230 Alamo, Newton, KS 67114.
Legal Description: Pt of SW ¼ of Sec 5-T21S-R1E.

Public Hearing
Marion County Board of Zoning Appeals
January 27, 2005
Marion County Courthouse
7:30 PM