

MARION COUNTY COURTHOUSE

MARION COUNTY KANSAS OFFICE OF THE PLANNING COMMISSION

230 E Main
P.O. BOX 137

MARION, KANSAS 66861

PHONE (620) 382-2550

Toll Free 1-800-305-8848

Per Marion County Zoning Regulations: All surrounding property owners within 5,280 feet (1 mile) of an area proposed to be altered, shall be notified by mail at least 20 days prior to the public hearing. If you are receiving this notice, you are within the specified notification area of a property whose owner has made application to the Marion County Planning Commission for a conditional use. If you will read the notice on this page, it will tell you who the property owner is, what they are requesting, and when the public hearing will be held. You may attend this hearing at the date and time listed below.

T-20-21-S

FAIRPLAY PLAT
(Landowners)



R-4

T-20-21-S

DOYLE PLAT
(Landowners)

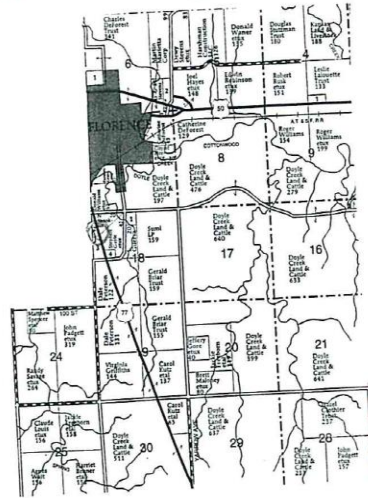

R-4-5-E

(First Published in the Marion County Record, Hillsboro Star Journal, Peabody Gazette, Wednesday, July 4, 2007)

NOTICE PUBLICATION Conditional Use Pending

Application: US Cellular
Owner: Robert B. Gayle
Conditional Use: Cell Tower
Address: 1070 Highway 77, Florence, KS 66851
Legal Description: NW1/4 of Section 18, Township 21, Range 5.

Public Hearing
Marion County Planning Commission
July 26, 2007
Marion County Courthouse
7:30 P.M.