



MARION COUNTY KANSAS  
**OFFICE OF THE PLANNING COMMISSION**

P.O. BOX 157  
 MARION, KANSAS 66861  
 PHONE (620) 382-2550  
 Toll Free 1-800-305-8848

Per Marion County Zoning Regulations: All surrounding property owners within 1,000 feet of an area proposed to be changed, shall be notified by mail twenty (20) days prior to the public hearing. If you are receiving this notice, you are within 1,000 feet of a property whose owner has made application to the Marion County Planning Commission for a variance. If you will read the notice on this page, it will tell you who the property owner is, what they are requesting, and when the public hearing will be held. You may attend this hearing at the date and time listed below.

**T-19-20-5**

**R-3-4-E**

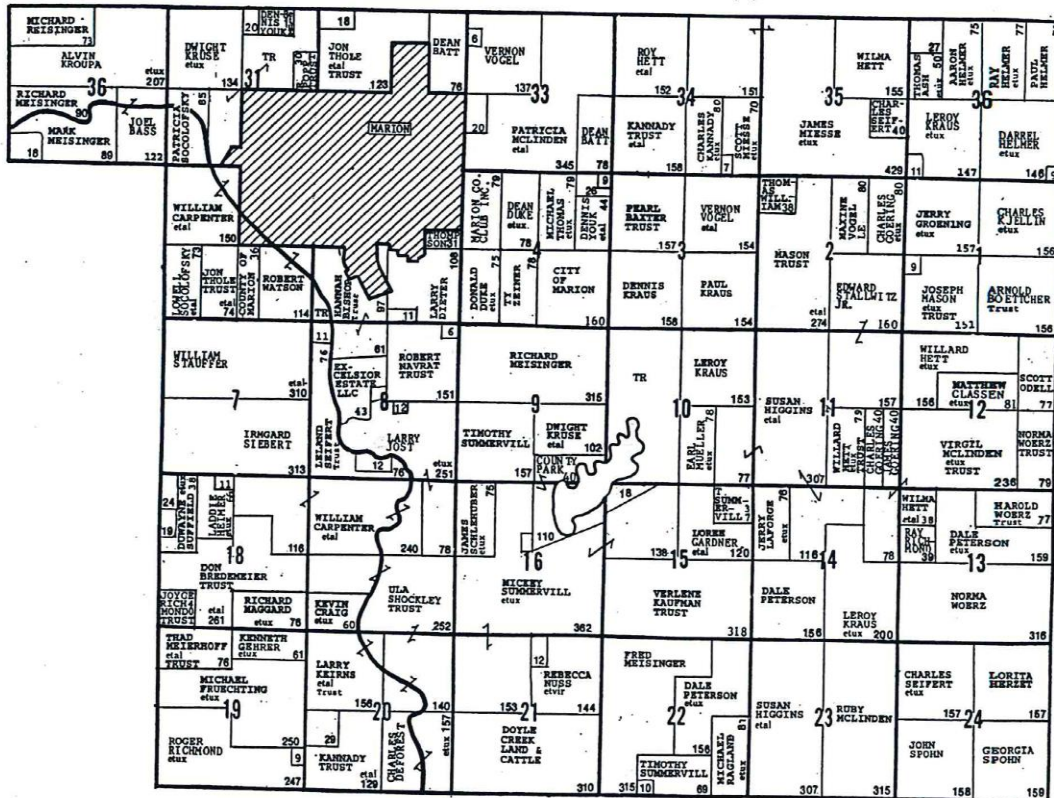

(First Published in the Hillsboro Free Press, Wednesday, March 2, 2005)

**NOTICE  
 PUBLICATION  
 Variance Pending**

Application: William Kaempfe  
 Variance: From required backyard setback of 50 feet to 29 feet.  
 Address: 19 Echo Lane, Marion, KS 66861  
 Legal Description: Lot 19 & 20, Echo Lane Subdivision.

**Public Hearing**  
**Marion County Board of Zoning Appeals**  
**March 24, 2005**  
**Marion County Courthouse**  
**7:30 PM**