



MARION COUNTY COURTHOUSE

MARION COUNTY KANSAS OFFICE OF THE PLANNING COMMISSION

P.O. BOX 157
MARION, KANSAS 66861
PHONE (620) 382-2550
Toll Free 1-800-305-8848

Per Marion County Zoning Regulations: All surrounding property owners within 1,000 feet of an area proposed to be changed, shall be notified by mail twenty (20) days prior to the public hearing. If you are receiving this notice, you are within 1,000 feet of a property whose owner has made application to the Marion County Planning Commission for a variance. If you will read the notice on this page, it will tell you who the property owner is, what they are requesting, and when the public hearing will be held. You may attend this hearing at the date and time listed below.

T-19-20-S

R-3-4-E

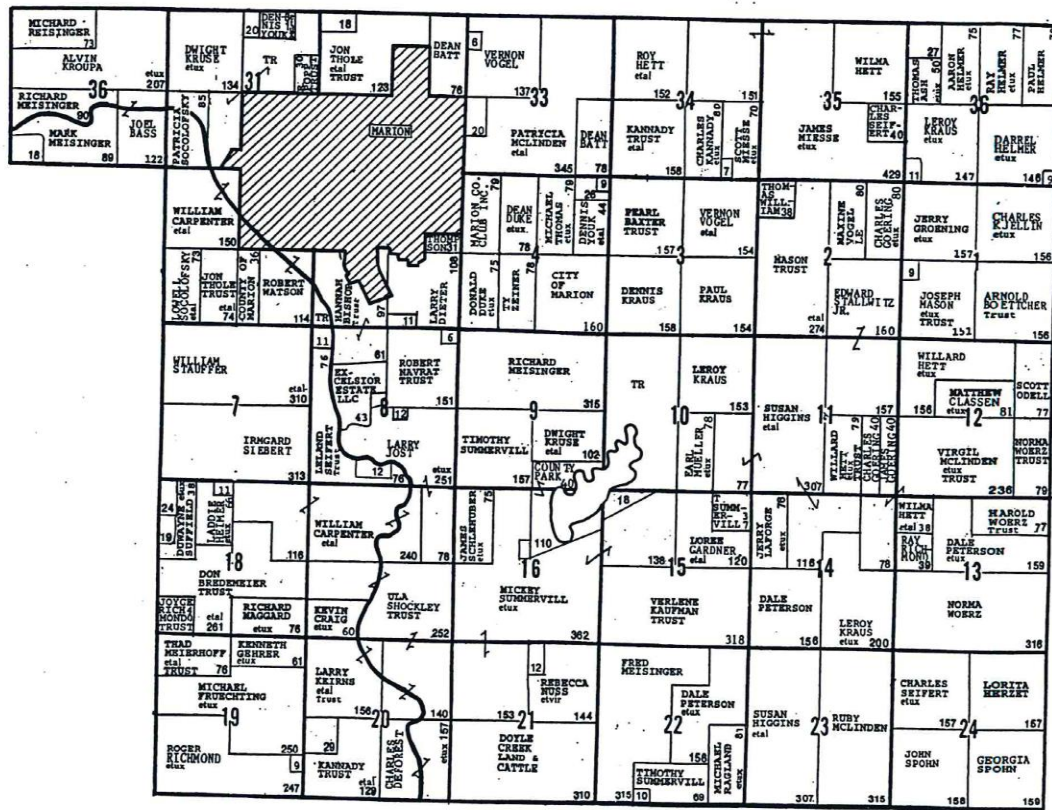

(First Published in the Hillsboro Free Press, Wednesday, March 2, 2005)

NOTICE PUBLICATION Variance Pending

Application: Ron Beeton
Variance: From front yard maximum fence height requirement of 3' to 5' and from required setback to property line.
Address: 6 Hill Road, Marion, KS 66861
Legal Description: Pt of SW ¼ Sec 10-T20S-R4E.

Public Hearing
Marion County Board of Zoning Appeals
March 24, 2005
Marion County Courthouse
7:30 PM