

MARION COUNTY COURTHOUSE

MARION COUNTY KANSAS
OFFICE OF THE PLANNING COMMISSION

P.O. BOX 157
 MARION, KANSAS 66861
 PHONE (620) 382-2550
 Toll Free 1-800-305-8848

Per Marion County Zoning Regulations: All surrounding property owners within 5, 280 feet of an area proposed to be altered, shall be notified by mail at least 20 days prior to the public hearing. If you are receiving this notice, you are within 5,280 feet of property whose owner has made application to the Marion County Planning Commission for a conditional use. If you will read the notice on this page, it will tell you who the property owner is, what they are requesting, and when the public hearing will be held. You may attend this hearing at the date and time listed below.

T-19-S

RISLEY PLAT
 (Landowners)

R-2-E

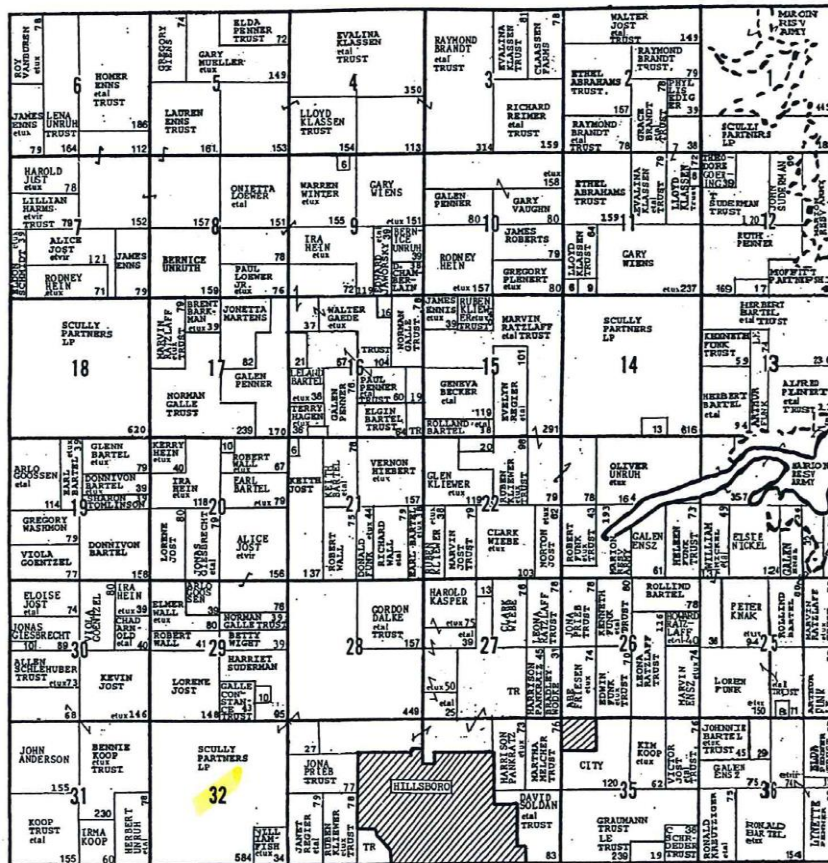

(First Published in the Hillsboro Free Press, Wednesday, May 4, 2005)

**NOTICE
 PUBLICATION**
 Conditional Use Pending

Application: Scully Partners/Western Wireless
 Conditional Use: Wireless communications facility
 Design: Support Tower
 Height: 220 feet
 Type: Guyed Tower
 Frequency of Antenna: 824-835 MHz and 869-880 MHz
 Legal Description: Pt of NW ¼ of Sec 32-T19S-R2E

Public Hearing
 Marion County Planning Commission
 May 26, 2005
 Marion County Courthouse
 7:30 PM